

no. onderdelen Schoffelmachine

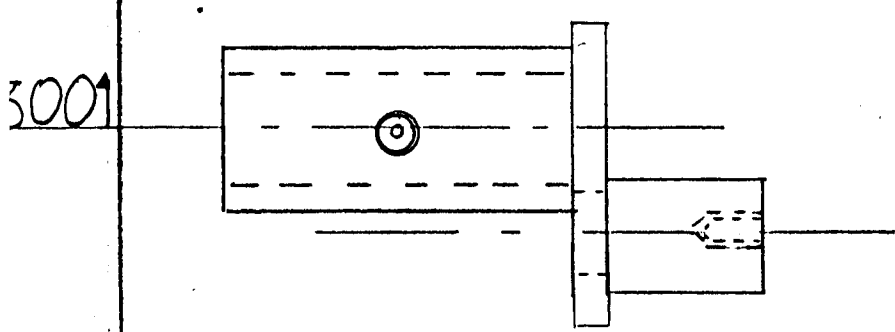

excentriek  
1 x rechts  
9 x Links



schoffel ARM

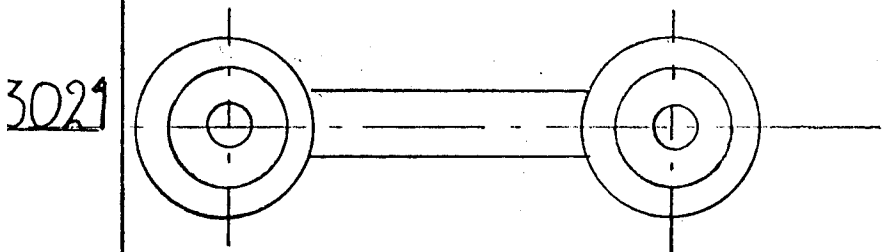

Lager ARM

3032 = BCS uitvoering.

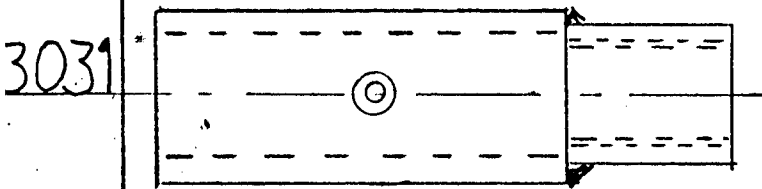

koppelbus

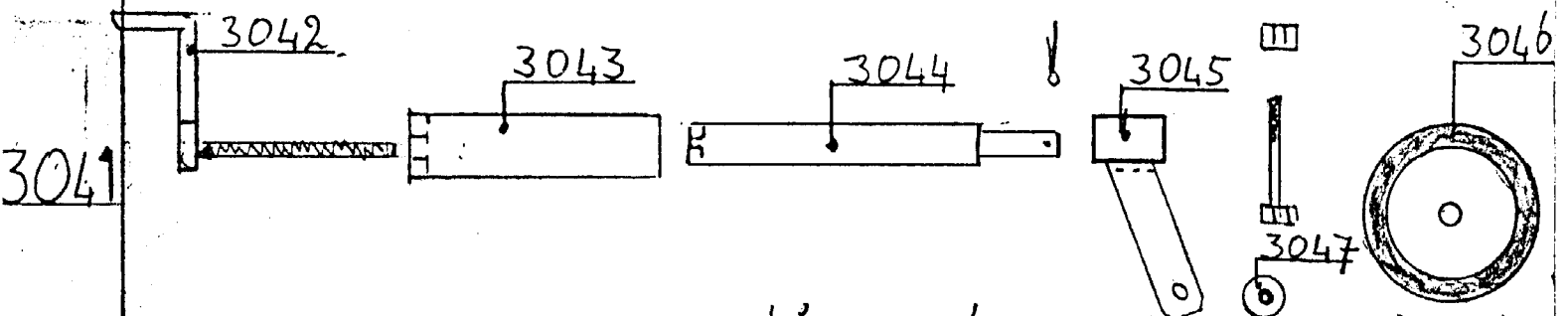

dieptestelwiel

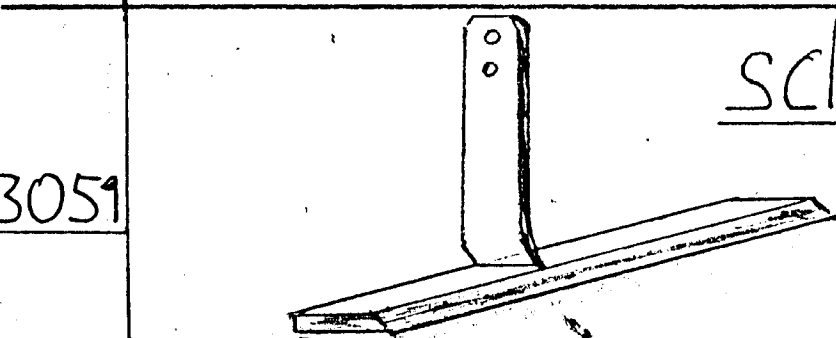

schoffelm es

4 x rechts  
4 x links

## Simloz Schoffelmachine

Drijfwerk: 3 Kogellager 25-52-15  
1 Kogellager 25-62-17  
2 Keerringen 25-47-7  
1 Keerring 25-35-7 of 25-47-7

### In de Schoffelarmen:

4 Kogellagers 25-47-12-2RS

Drijfwerk: Comer bakje 124 020